

PE364TS-60-2

GENERAL PURPOSE ELECTRIC MOTOR

NEMA PREMIUM EFFICIENCY

TOTALLY ENCLOSED FAN COOLED

INVERTER DUTY 10:1 CT; 20:1 VT - NEMA MG1 PART 31

Factory Certified for T2B Class I, Division II, Groups A,B,C & D and Class II, Division II, Groups F & G

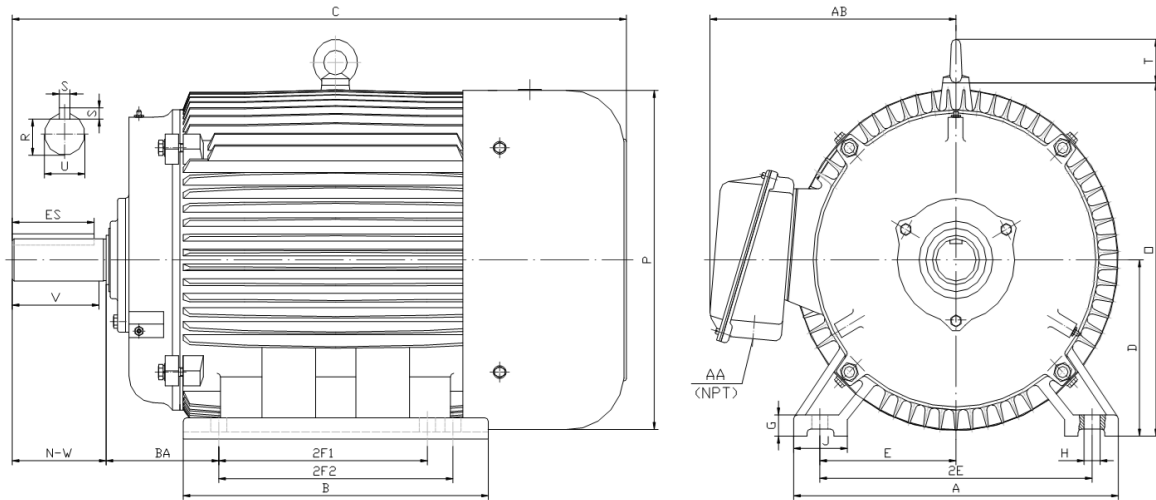

DIMENSIONS

| HP | RPM | Frame | MOUNTING | | | | | | | | | | | | | | |
|----|------|-------|----------|-------|-------|------|------|------|------|------|-------|-------|-------|-------|-------|------|------|
| | | | A | B | C | D | G | H | J | E | 2E | 2F1 | 2F2 | O | P | T | BA |
| 60 | 3600 | 364TS | 17.10 | 15.40 | 31.40 | 9.00 | 1.15 | 0.66 | 2.95 | 7.00 | 14.00 | 11.25 | 12.25 | 18.10 | 17.60 | 2.60 | 5.88 |

| Shaft Extension, Key Set | | | | | | Conduit Box | | Bearings | | Mount |
|--------------------------|------|-------|-------|------|------|-------------|-------|----------|------|-------|
| U | V | R | S | ES | N-W | AA | AB | DE | ODE | |
| 1.875 | 3.50 | 1.591 | 0.500 | 2.03 | 3.75 | 3.00 | 14.60 | 6313 | 6313 | F1 |

BEARING LUBRICATION: The bearings come lubricated with Mobil Polyrex EM Polyurea Grease. It is recommended that you add some additional lubrication when the motor is installed.

Three options (brands) for suitable lubrication include, but are not limited to, the following:

- 1.) Mobil Polyrex EM
- 2.) Citco Polyurea MP
- 3.) Conoco Phillips Polytac EP





PE364TS-60-2

GENERAL PURPOSE ELECTRIC MOTOR

NEMA PREMIUM EFFICIENCY

TOTALLY ENCLOSED FAN COOLED

INVERTER DUTY 10:1 CT; 20:1 VT - NEMA MG1 PART 31







Factory Certified for T2B Class I, Division II, Groups A,B,C & D and Class II, Division II, Groups F & G

PERFORMANCE DATA

| HP | RPM | Frame | Voltage | Frequency (Hz) | Full Load S.F. | Insulation Class | NEMA Design | Slip (%) | NEMA Code | Enclosure Type | IP Rating | Max. Ambient |
|----|------|-------|-------------|----------------|----------------|------------------|-------------|----------|-----------|----------------|-----------|--------------|
| 60 | 3565 | 364TS | 208-230/460 | 60 | 1.15 | F | B | 1.0 | G | TEFC | 55 | 40° C |

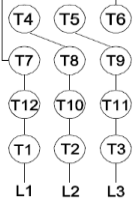
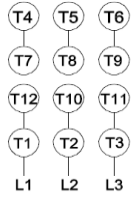
| Amps (460V) | | Efficiency (%) | | | | Power Factor | | | Torque (ft-lb) | | | DE Bearing | ODE Bearing | Connection | Weight (lbs.) |
|-------------|-----|----------------|------|------|------|--------------|-------|-------|----------------|-------|-------|------------|-------------|--------------|---------------|
| FLA | LRA | 100% | 75% | 50% | Min. | 100% | 75% | 50% | FLT | LRT % | BDT % | | | | |
| 66.0 | 435 | 93.6 | 93.0 | 92.4 | 92.4 | 0.920 | 0.900 | 0.850 | 88.6 | 140 | 255 | 6313 | 6313 | 12 Lead 2Δ/Δ | 805 |

NAME PLATE

| | | | | | | | | | | | | | | | |
|--|------------|-------------------------|---------------|-----------------------|--------|-----------|--|--|-------|---|--|--|--|--|--|
|  North American Electric, Inc. | | | | | | | | | |  | | | CONNECTION DIAGRAMS 208-230V  | | |
| INVERTER DUTY 20:1 VT; 10:1 CT | | | | | | | | | | | | | | | |
| CAT NO: PE364TS-60-2 | | | FRAME 364TS | | | PHASE 3 | | | | | | 460V  | | | |
| HZ 60 | S.F. 1.15 | HZ 50 | S.F. 1.0 | ENCL TEFC | IP 55 | | | | | | | | | | |
| HP 60 | RPM 3565 | HP 60 | RPM 2960 | DUTY CONT | DES B | | | | | | | | | | |
| VOLTS 208-230/460 | | | VOLTS 190/380 | | | AMB 40° C | | | INS F | | | | | | |
| FLA 146 - 132 / 66 | FLA 160/80 | | | DE BEARING 6313 | | | | | | | | | | | |
| CODE G | P.F. 0.92 | CODE F | P.F. 0.93 | ODE BEARING 6313 | | | | | | | | | | | |
| EFF 93.6 | MIN 92.4 | EFF 92 | MIN 90.8 | LUB: Mobil Polyrex EM | | | | | | | | | | | |
| MOTOR WEIGHT 805 LBS | | CONNECTION 12 Lead 2Δ/Δ | | | SER NO | | | | | | | | | | |
| General purpose use on industrial machinery installed in damp, dusty or dirty environments. Hernando, Mississippi | | | | | | | | | |    CC 082A | | | | | |

APPLICATIONS:

General purpose use on pumps, fans, blowers, compressors, conveyors, material handling and other industrial machinery installed in damp, dusty or dirty environments.