

PEXP365TS-75-2

EXPLOSION PROOF ELECTRIC MOTOR

NEMA PREMIUM EFFICIENCY

TOTALLY ENCLOSED FAN COOLED; EXPLOSION PROOF ENCLOSURE

CLASS I DIVISION I GROUP C & D; CLASS II DIVISION I GROUP F & G

OPERATING TEMP CODE T3C

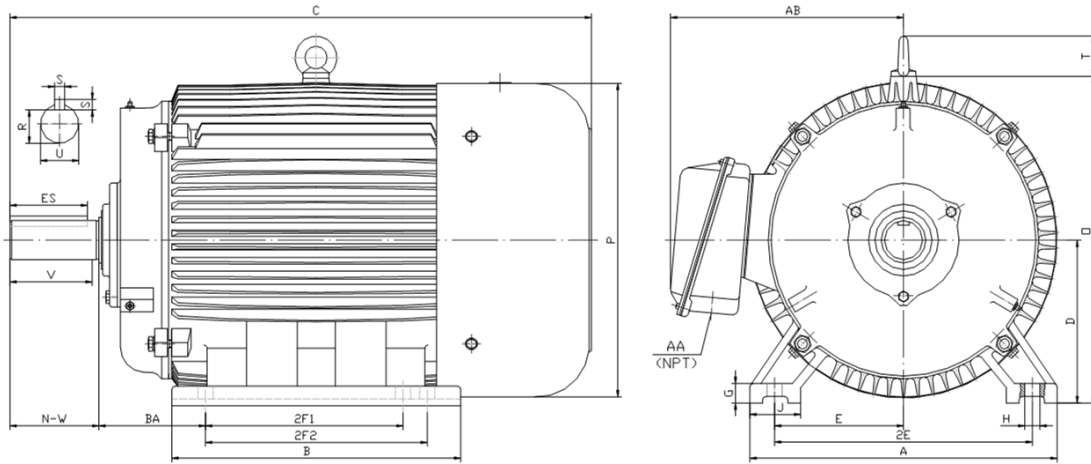

DIMENSIONS

HP	RPM	Frame	MOUNTING														
			A	B	C	D	G	H	J	E	2E	2F1	2F2	O	P	T	BA
75	3600	365TS	17.10	15.40	31.40	9.00	1.15	0.66	2.95	7.00	14.00	11.25	12.25	18.10	17.60	2.60	5.88

Shaft Extension, Key Set						Conduit Box		Bearings		Mount
U	V	R	S	ES	N-W	AA	AB	DE	ODE	
1.88	3.50	1.59	0.50	2.03	3.75	3.00	14.60	6313	6313	F1

BEARING LUBRICATION: The bearings come lubricated with Mobil Polyrex EM Polyurea Grease. It is recommended that you add some additional lubrication when the motor is installed.

Three options (brands) for suitable lubrication include, but are not limited to, the following:

- 1.) Mobil Polyrex EM
- 2.) Citco Polyurea MP
- 3.) Conoco Phillips Polytac EP









PEXP365TS-75-2
EXPLOSION PROOF ELECTRIC MOTOR
NEMA PREMIUM EFFICIENCY
TOTALLY ENCLOSED FAN COOLED; EXPLOSION PROOF ENCLOSURE
CLASS I DIVISION I GROUP C & D; CLASS II DIVISION I GROUP F & G
OPERATING TEMP CODE T3C
PERFORMANCE DATA

HP	RPM	Frame	Voltage	Frequency (Hz)	Full Load S.F.	Insulation Class	NEMA Design	Slip (%)	NEMA Code	Enclosure Type	IP Rating	Max. Ambient	Oper Temp Code	Max. KVAR
75	3573	365TS	208-230/460	60	1.15	F	B	0.8	G	TEXP	55	40° C	T3C	16.7

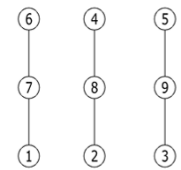
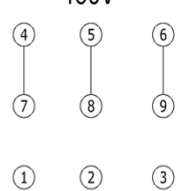
Amps (460V)		Max. Amps (208V)	Efficiency (%)				Power Factor			Torque (ft-lb)			DE Bearing	ODE Bearing	Connection	Weight (lbs.)
FLA	LRA	60HZ	100%	75%	50%	Min.	100%	75%	50%	FLT	LRT %	BDT %				
84.5	542.5	186.9	93.6	93.6	93.2	92.4	0.88	0.88	0.84	110.9	105	200	6313	6313	9 Lead 2Δ/Δ	946

NAME PLATE

 North American Electric, Inc.															CONNECTION DIAGRAMS 208V-230V 				
PREMIUM EFFICIENT EXPLOSION PROOF MOTOR																			
CAT NO: PEXP365TS-75-2			FRAME 365TS			PHASE 3				460V 									
DE BRG 6313		ODE BRG 6313		CONN. 9 Lead 2Δ/Δ															
MAX AMB. 40° C		INS. CLASS F		RATING CONT		WEIGHT 946													
USABLE ON 208V 60HZ AT 186.9			MAX AMPS		SER														
DIVISION 1 CLASS I GROUP C D CLASS II GROUP F G						OPER TEMP CODE T3C													
60 HERTZ DATA	HP 75		RPM 3573		HP 75		RPM 2978		50 HERTZ DATA										
	VOLTS 208-230/460				VOLTS 190/380														
	F.L. AMPS 186.9 - 169 / 84.5				F.L. AMPS 204.6/102.3														
	S.F. AMPS 97.2				S.F. AMPS 204.6/102.3														
	S.F. 1.15 DESIGN B CODE G				S.F. 1.0 DESIGN B CODE H														
	NEMA NOM.EFF. 93.6 % P.F. 0.88				NEMA NOM.EFF. 94.3 % P.F. 0.88														
	NEMA MIN.EFF. 92.4 %				NEMA MIN.EFF. 93.2 %														
MAX. KVAR 16.7		LUB. Mobil Polyrex EM																	
<small>General purpose use on industrial machinery installed in damp, dusty or dirty environments. These motors are designed for use in hazardous locations defined by class and group.</small>																			
   CC 041B																			
Hernando, Mississippi																			

	ELECTRIC MOTORS FOR HAZARDOUS LOCATIONS CLASS I DIVISION I GROUP C D, CLASS II DIVISION I GROUP F G NO. CCXXXXX E310089
---	--

APPLICATIONS:

General purpose use on pumps, fans, blowers, compressors, conveyors, material handling and other industrial machinery installed in damp, dusty or dirty environments. These motors are designed to be used in hazardous locations as defined by class and group.