

VHS1-100S4-W40416A-EHT

VERTICAL HOLLOW SHAFT MOTOR

NEMA PREMIUM EFFICIENCY

EXTRA HIGH THRUST DESIGN

THREE PHASE, OPEN DRIP PROOF (WP1) ENCLOSURE

NON-REVERSE BALL BEARING RATCHET

COUPLING INCLUDED

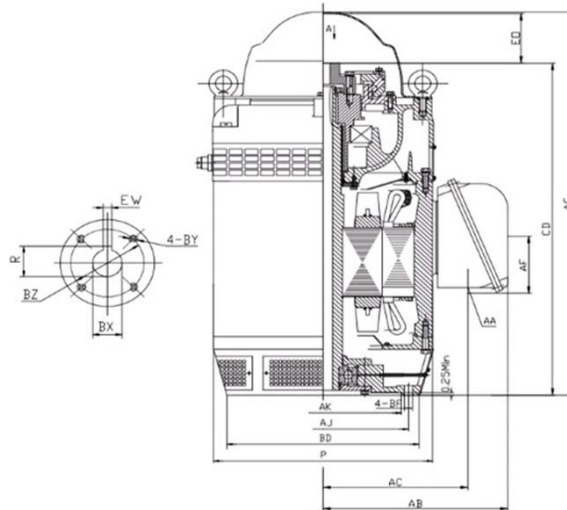

DIMENSIONS

HP	RPM	Frame	MOUNTING DIMENSIONS													
			BD	AJ	AK	BF	BX	BZ	EW	R	BY	CD	E0 >	AC	AA	AF
100	1770	404TP	16.50	14.750	13.50	0.69	1.50	2.13	0.38	1.706	1/4-20	36.94	6.46	16.18	3" NPT	7.56

OVERALL DIMENSIONS			BEARINGS	
P	AB	AG	UPPER	BOTTOM
23.30	20.70	43.40	7230B/DT	6317

COUPLING: Motor comes with a 1.50 coupling. You may select a different size coupling at no extra charge.

BEARING LUBRICATION: The bottom bearing comes lubricated with Mobile Polyrex EM Polyurea Grease.

OIL RESERVOIR: Motor is shipped without oil. The oil capacity is 4.82 quarts.

STEADY BUSHING: Motor is designed to accept a steady bushing. The bore size is 2.047 inches.



VHS1-100S4-W40416A-EHT

VERTICAL HOLLOW SHAFT MOTOR

NEMA PREMIUM EFFICIENCY

EXTRA HIGH THRUST DESIGN

THREE PHASE, OPEN DRIP PROOF (WP1) ENCLOSURE







NON-REVERSE BALL BEARING RATCHET

PERFORMANCE DATA

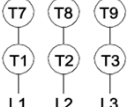
HP	RPM	Frame	Voltage	Frequency (Hz)	Full Load S.F.	Insulation Class	NEMA Design	Slip (%)	NEMA Code	Enclosure Type	IP Rating	Max. Ambient	Rating CONT
100	1788	404TP	460	60	1.15	F	B	0.7	H	WP1	23	40° C	S1

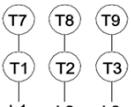
Amps (460V)		Efficiency (%)				Power Factor			Torque (ft-lb)			Down Thrust	Angular Contact Bearing	Radial Ball Bearing	Connection	Weight (lbs.)
FLA	LRA	100%	75%	50%	Min.	100%	75%	50%	FLT	LRT %	BDT %	13400	UPPER	BOTTOM	6 Lead Δ	1399
112.0	818	95.4	94.0	92.0	94.5	0.88	0.88	0.82	292	220	240		7230B/DT	6317		

NAME PLATE

 North American Electric, Inc.				VERTICAL HOLLOW SHAFT ELECTRIC MOTOR				CONNECTION DIAGRAMS					
INVERTER DUTY 10:1 VT; 5:1 CT				EXTRA HIGH THRUST DESIGN									
MODEL	VHS1-100S4-W40416A-EHT			PHASE	3	Hz	60			Across The Line 			
HP	100	FRAME	404TP	VOLTS	460			PWS Start 					
DESIGN	B	CODE	H	AMPS	112								
NOM EFF.	95.4	P.F.	0.88	INSULATION CLASS	F			PWS Run 					
RATING CONT	S1	S.F.	1.15	MAX AMB.	40° C	WEIGHT	1399 LBS.						
DOWN THRUST	13400			ENCLOSURE TYPE	WP1								
UPPER BEARING	7230B/DT	0.0	BOTTOM BEARING	6317									
OIL CAP.	UPPER BEARING	4.82	QTS	LUBRICATION	MOBILE POLYREX EM								
NON-REVERSE RATCHET - BALL TYPE				SERIAL NO.									
Specifically designed for use on deep well turbine pump applications.				   									
Hernando, Mississippi													

APPLICATIONS:

Specifically designed for use on deep well turbine pump applications. The coupling is equipped with a non-reverse ratchet, which prevents motor rotation from backspin at shutdown. These motors are built to NEMA standards and have special bearing arrangements to carry heavy thrust loads.