

**VHS1-250S4-W44516A-EHT**

VERTICAL HOLLOW SHAFT MOTOR

**NEMA PREMIUM EFFICIENCY**

EXTRA HIGH THRUST DESIGN

THREE PHASE, OPEN DRIP PROOF (WP1) ENCLOSURE

NON-REVERSE BALL BEARING RATCHET

COUPLING INCLUDED

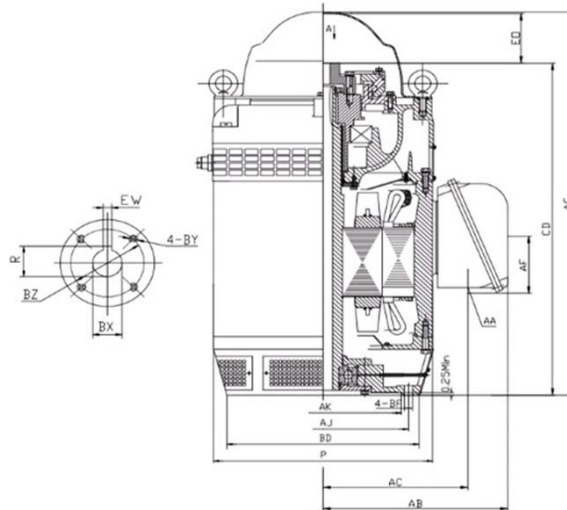

**DIMENSIONS**

HP	RPM	Frame	MOUNTING DIMENSIONS													
			BD	AJ	AK	BF	BX	BZ	EW	R	BY	CD	E0 >	AC	AA	AF
250	1780	445TP	16.50	14.750	13.50	0.69	1.938	2.50	0.51	2.160	1/4-20	42.66	5.40	16.18	3" NPT	7.56

OVERALL DIMENSIONS			BEARINGS	
P	AB	AG	UPPER	BOTTOM
23.30	20.70	48.03	7232B/DT	6318

**COUPLING:** Motor comes with a 1.938 coupling. You may select a different size coupling at no extra charge.

**BEARING LUBRICATION:** The bottom bearing comes lubricated with Mobile Polyrex EM Polyurea Grease.

**OIL RESERVOIR:** Motor is shipped without oil. The oil capacity is 6 quarts.

**STEADY BUSHING:** Motor is designed to accept a steady bushing. The bore size is 2.362 inches.



## VHS1-250S4-W44516A-EHT

VERTICAL HOLLOW SHAFT MOTOR

**NEMA PREMIUM EFFICIENCY**

EXTRA HIGH THRUST DESIGN

THREE PHASE, OPEN DRIP PROOF (WP1) ENCLOSURE





NON-REVERSE BALL BEARING RATCHET

### PERFORMANCE DATA

HP	RPM	Frame	Voltage	Frequency (Hz)	Full Load S.F.	Insulation Class	NEMA Design	Slip (%)	NEMA Code	Enclosure Type	IP Rating	Max. Ambient	Rating CONT
250	1788	445TP	460	60	1.15	F	B	0.7	F	WP1	23	40° C	S1

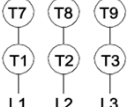
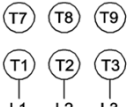
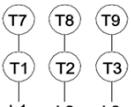
Amps (460V)		Efficiency (%)				Power Factor			Torque (ft-lb)			Down Thrust	Angular Contact Bearing	Radial Ball Bearing	Connection	Weight (lbs.)
FLA	LRA	100%	75%	50%	Min.	100%	75%	50%	FLT	LRT %	BDT %	14400	UPPER	BOTTOM	6 Lead Δ	2225
276.0	1849	95.8	94.5	93.1	95.0	0.88	0.87	0.81	730	168	220		7232B/DT	6318		

### NAME PLATE

 <p>North American Electric, Inc. VERTICAL HOLLOW SHAFT ELECTRIC MOTOR</p> <p>INVERTER DUTY 10:1 VT; 5:1 CT</p> <p>EXTRA HIGH THRUST DESIGN</p>				CONNECTION DIAGRAMS				
MODEL	VHS1-250S4-W44516A-EHT	PHASE	3	Hz	60	<p>Across The Line</p> 		
HP	250	FRAME	445TP	VOLTS	460			
DESIGN	B	CODE	F	AMPS	276			
NOM EFF.	95.8	P.F.	0.88	INSULATION CLASS	F	<p>PWS Start</p> 		
RATING CONT	S1	S.F.	1.15	MAX AMB.	40° C		WEIGHT	2225 LBS.
DOWN THRUST	14400	ENCLOSURE TYPE	WP1	UPPER BEARING	7232B/DT (X 2) EHT		BOTTOM BEARING	6318
OIL CAP.	UPPER BEARING 6 QTS	LUBRICATION	MOBILE POLYREX EM	NON-REVERSE RATCHET - BALL TYPE	SERIAL NO.	<p>PWS Run</p> 		
Specifically designed for use on deep well turbine pump applications.		   						
Hernando, Mississippi								

### APPLICATIONS:

Specifically designed for use on deep well turbine pump applications. The coupling is equipped with a non-reverse ratchet, which prevents motor rotation from backspin at shutdown. These motors are built to NEMA standards and have special bearing arrangements to carry heavy thrust loads.